

# Holland Energy Park™





Three goals were developed by the Blue Ribbon panel:

- \* Develop a Resource
- \* Create a Destination
- \* Enhance a Gateway

## Plant Rendering

Artist renderings were based on Architectural Blue Ribbon panel input. The building envelope helps contain noise while improving the look and feel of a traditional plant.



## Before Demolition

*Cleaning up a forgotten and decaying neighborhood*

# Major Equipment and Features

- Two Siemens SGT-800 combustion turbine generators
- Two Vogt heat recovery steam generators
- One Siemens SST-400 steam turbine
- 145 MW Winter/125 MW Summer
- One English Boiler auxiliary boiler
- A three-cell SPX cooling tower with plume-abatement
- Siemens T3000 Control System
- Five-fold expansion possible– to 2.5 million square feet – of the largest municipally-owned snowmelt system in the United States, with 720,000 square feet currently installed.

Check out this exciting  
new technology!



Clear Sky  
technology



# Site Layout

Trails, water features, and a new city park surround the power plant, which is located at the eastern entrance to the downtown area.





## Comparing Holland Energy Park to HBPW's retired coal plant, James De Young ("JDY")

- Twice as fuel efficient
- 50 percent reduction in carbon emissions
- Virtual elimination of sulfur & particulate matter
- Capability to expand snowmelt five-fold
- Opportunity to redevelop water-front property
- Sound abatement around equipment
- Dark-sky lighting

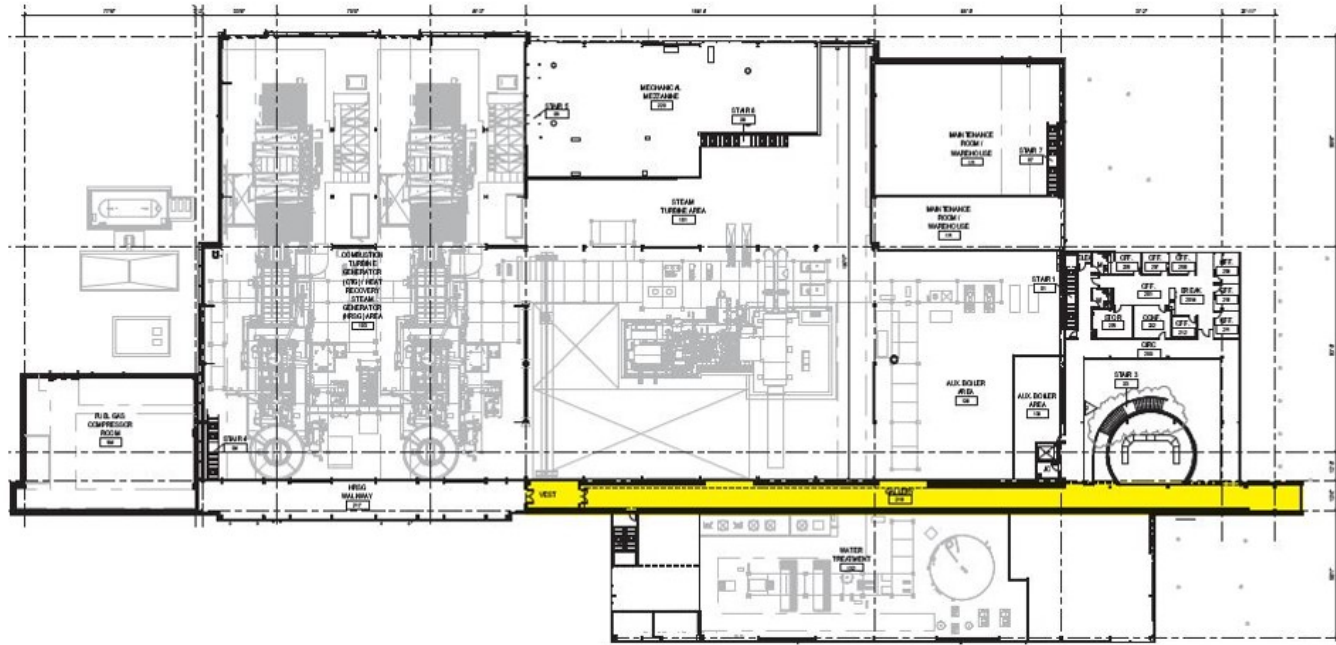

## Visitor's Center

The highlighted area shows the 3,780-square-foot the Visitor's Center. Intended to provide visitors with a learning experience, the Center provides an understanding of the role that public power generation has played in the past and will play in the future.



**Completed Visitor's Experience Center**



# Completed Project





**HOLLAND**  
ENERGY PARK